

# RSIC ACOUSTIC ASSEMBLY

## FLOOR CEILING ASSEMBLY

### DIRECT FIX TO WOOD OPEN WEB TRUSS

**PAC**  
International

World Leader in  
Noise Control Solutions



Toll Free (866) 774-2100 [WWW.PAC-INTL.COM](http://WWW.PAC-INTL.COM)

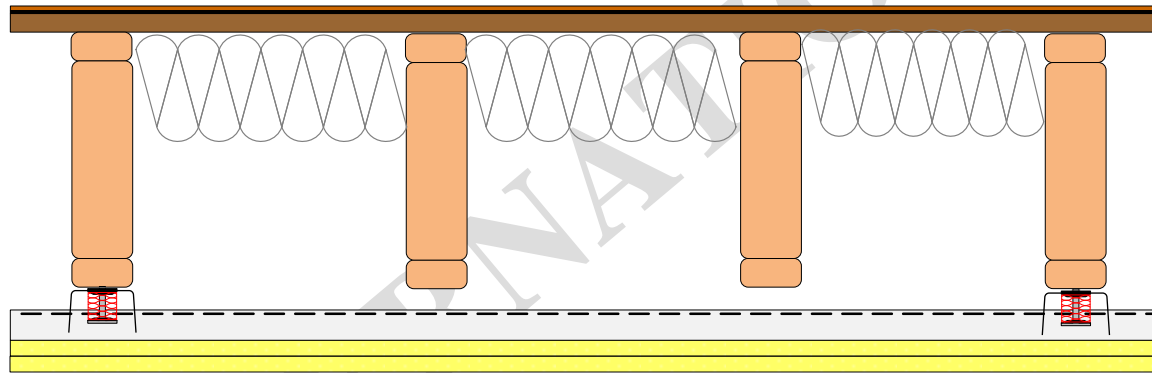

#### **CONSTRUCTION**

- 3/8 Snap N Go Hardwood
- 5mm Ecore Rubber Mat
- 1-1/4" Plywood
- 18" Open Web Truss @ 24" OC
- R-11 Fiberglass Insulation
- RISC-SI-X @ 16x48" OC
- 7/8" Drywall Furring Channel @ 16" OC
- 2 Layer 5/8" Type C

RAL TL20-070 IN20-005



**STC 61**

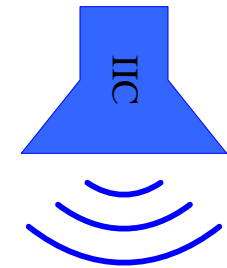

**IIC 58**