

RSIC ACOUSTIC ASSEMBLY

FLOOR CEILING ASSEMBLY

DIRECT FIX TO STEEL "C" JOIST

PAC
International

World Leader in
Noise Control Solutions



WFCi #07083 1 HOUR F-C Assembly



RSIC-1

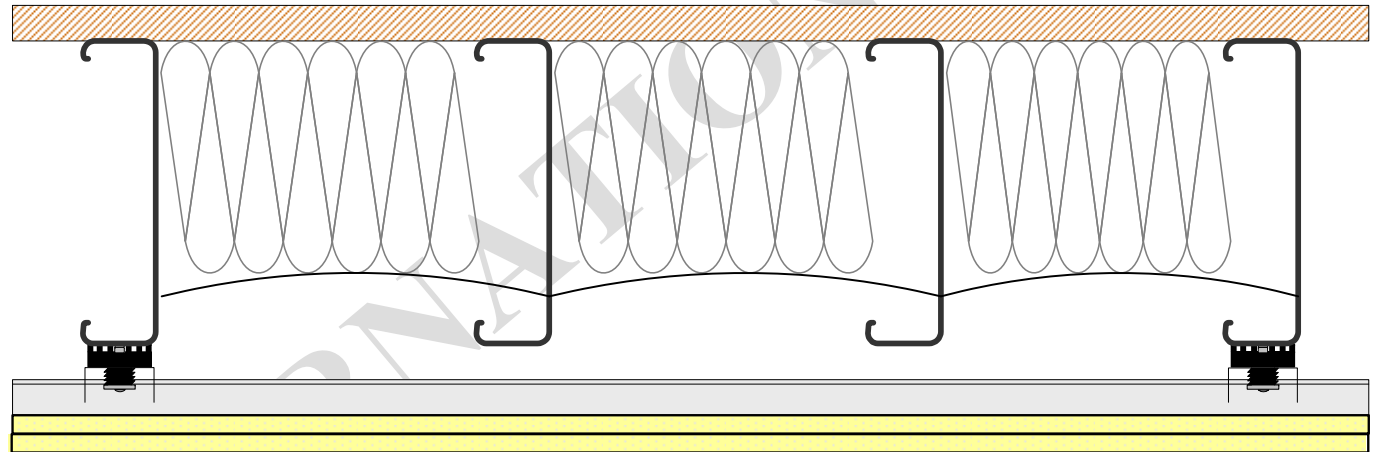

CONSTRUCTION

- 3/4" T&G PLYWOOD SUBFLOOR
- CEMCO 12" X 16 GA STEEL "C" SECTION JOIST @ 16" OC
- R-19 FIBERGLASS BATT INSULATION (NOM 6")
- RSIC-1 INSTALLED @ 48" OC
- 7/8" DRYWALL FURRING CHANNEL @ 24" OC
- 2 LAYERS 5/8" PABCO FIRE CODE "C" GYPSUM BOARD



1 HOUR

WFCi #07083

WFCi #07083 1 hour floor ceiling assembly